

DeHEUVEL

green co-working and collaboration spaces

While mainly serving as an office-building in the near Hinterland of Rotterdam, **DeHEUVEL** combines a variety of sustainable solutions for its energy consumption and service requirements.

The entire structure consists of two quarter-spherical shaped buildings covered in fertile soil, separated by one of the various rivers and streams around the city of Rotterdam. The main use of **DeHEUVEL** is the up and coming trend of people working together freely in co-working spaces instead of regular offices. While the infrastructure of a common city office can be quite limiting, the spaces inside of **DeHEUVEL** provide free roaming, spontaneous meetings and flexibility. Open architecture with lots of natural light and spacious rooms can increase comfort at work and boost creativity as well as quality and output.

«Home office» has become a more common form of how people do their work. However, research shows that it can be quite challenging to integrate working into the setting of the private living space. This can be due to infrastructure, family situation or lack of self-discipline. A large number of citizens who reside in the city of Rotterdam still have to take the heavily circulated routes to nearby cities such as The Hague or Amsterdam in order to be present at their employers respective office. **DeHEUVEL** provides a space for free workers close to their home while still giving the impression of having an office – instead of having the office at home. Placed in close proximity of the city's centre, **DeHEUVEL** is aimed at people who search for a place to work without taking the daily stress of heavy, enduring traffic or losing the work-life balance because of «regular» home-office.

Next to open office spaces, **DeHEUVEL** is completely self-sufficient. It's hill-like shape allows for agriculture around and on top of the structure itself. The cultivated crops are used in the internal cantina in combination with other, local food sources. Being a hill on a waterside, **DeHEUVEL** uses its position to generate wind energy as well as using the stream or river's flow to create electricity with its in-built watermills.

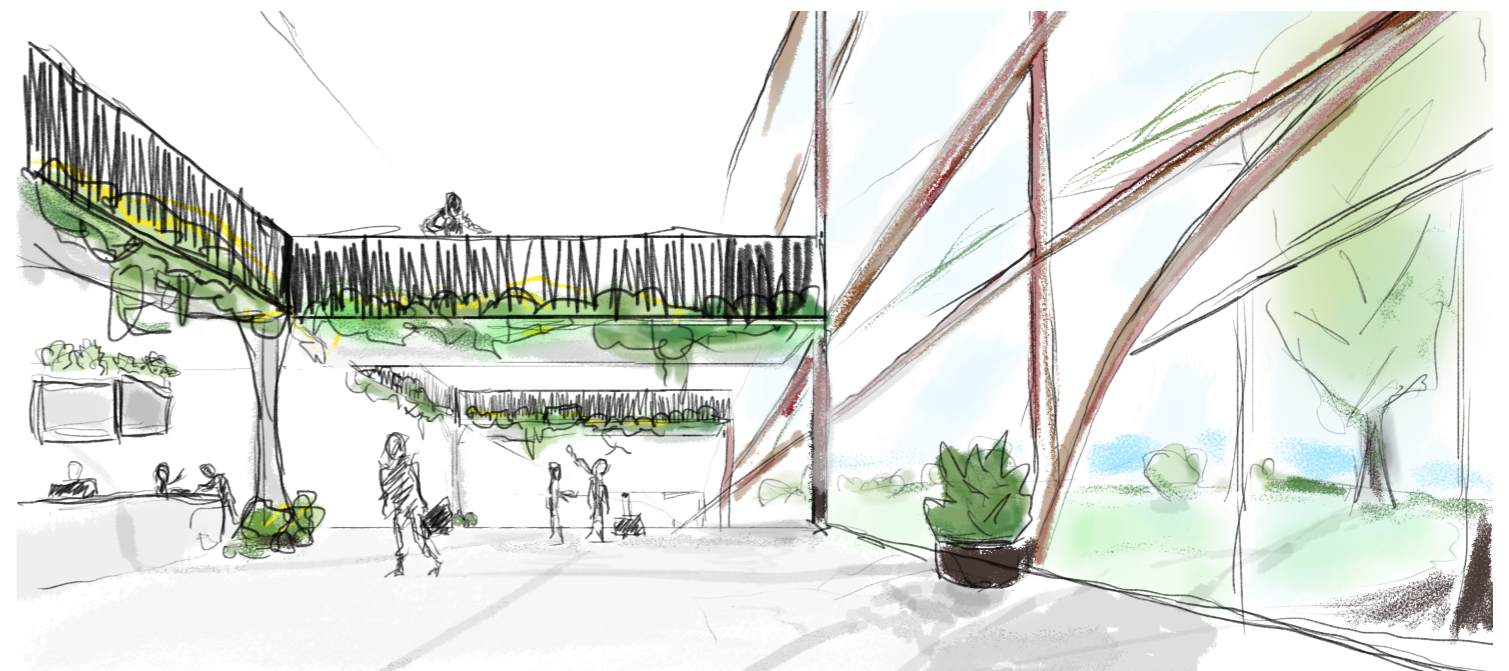
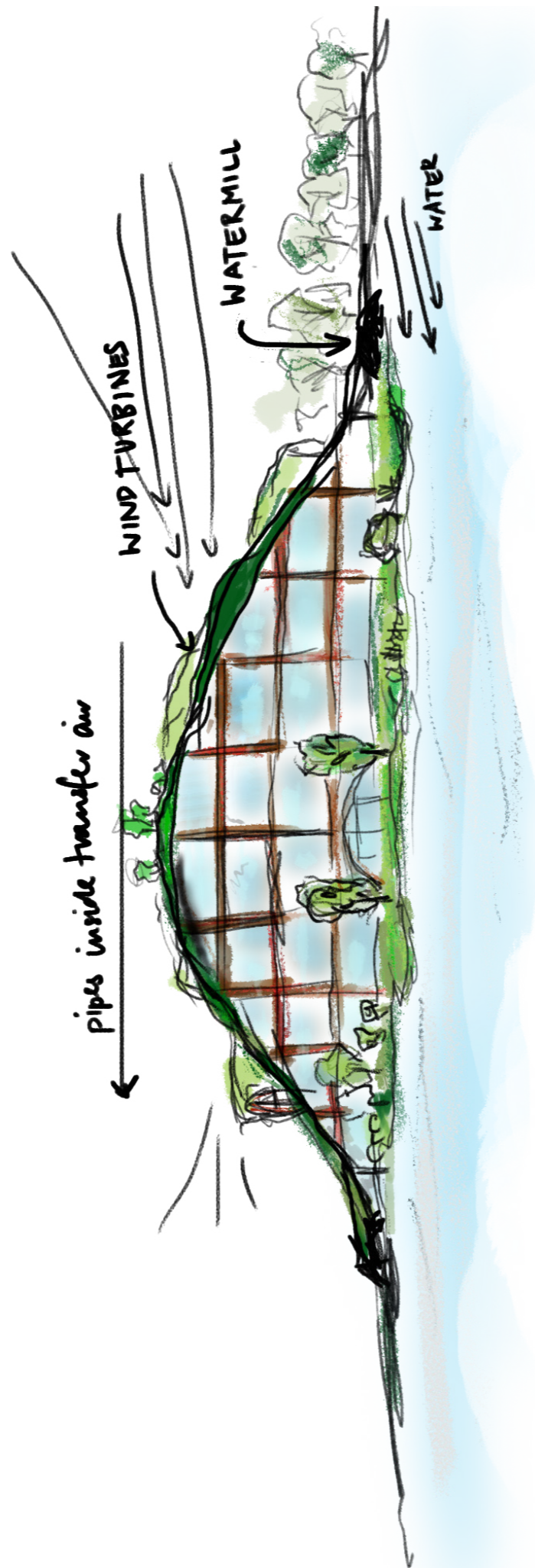



To create a liveable and lovely space the containers will be surrounded by a park with benches and trees. The people who live there should be using this space to make things together.



My Idea is «Container City»...

Rotterdam and its harbour are highly characterized by the transport industry. I would like to make the harbour and the boats' character to a new the city center. As there is a lack of living-space in Rotterdam the idea is to create new floating flats out of an old boat and containers.

This is possible with the «Container City». A small city that is built out of old containers on a boat should be the home for people and a small park.

One big advantage of this concept is that the rising sealevel is not a problem anymore and that all the materials are already there and just have to be rebuilt. So it is an ecofriendly home out of recycled materials.

Delia Haueter

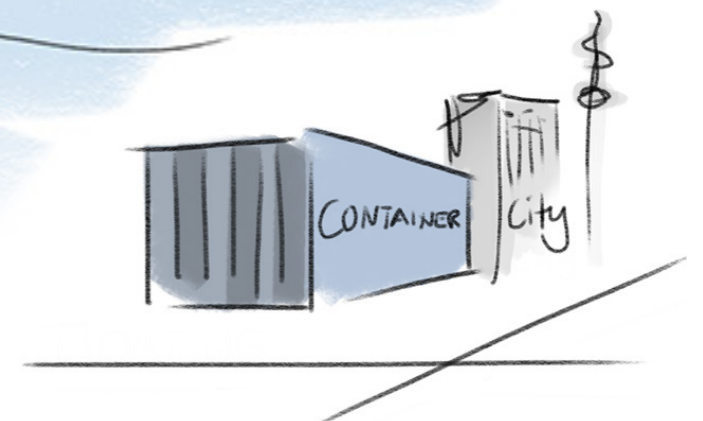

Football Island

Oliver Julier

Football has brought people of different age, gender or ethical origin together for decades. My idea should highlight this trait, by enabling the people of Rotterdam to play this beautiful game.

With a floating football field, people of almost every district have to travel only a few minutes to get to the pitch. For each day there is a spot in the city where the football island will cast its anchor for a day, so people of those districts – and of course other people as well – are able to play football. The morning after it is pulled by a boat to reach the next destination.

Because of the size of the construct the waves are no problem and won't affect its tilt, so the people can play without any external influences. The fence around the field should prevent the ball from falling into the river.

The whole watering situation is solved directly by the water of the Maas, so the pitch is always in a good condition. A pump brings up the necessary amount of water. Especially in the dry periods of the year, the grass would suffer from those circumstances.

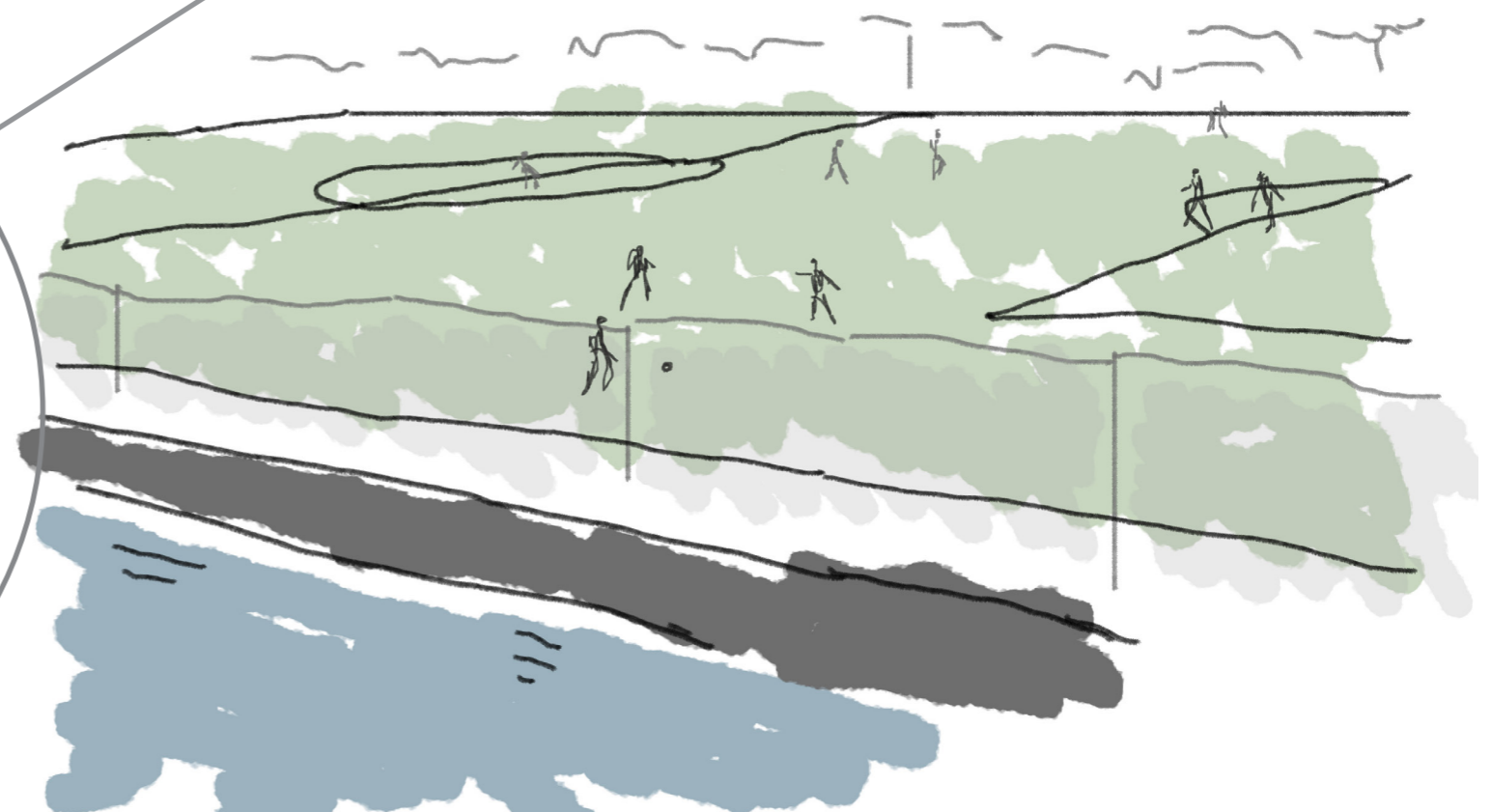
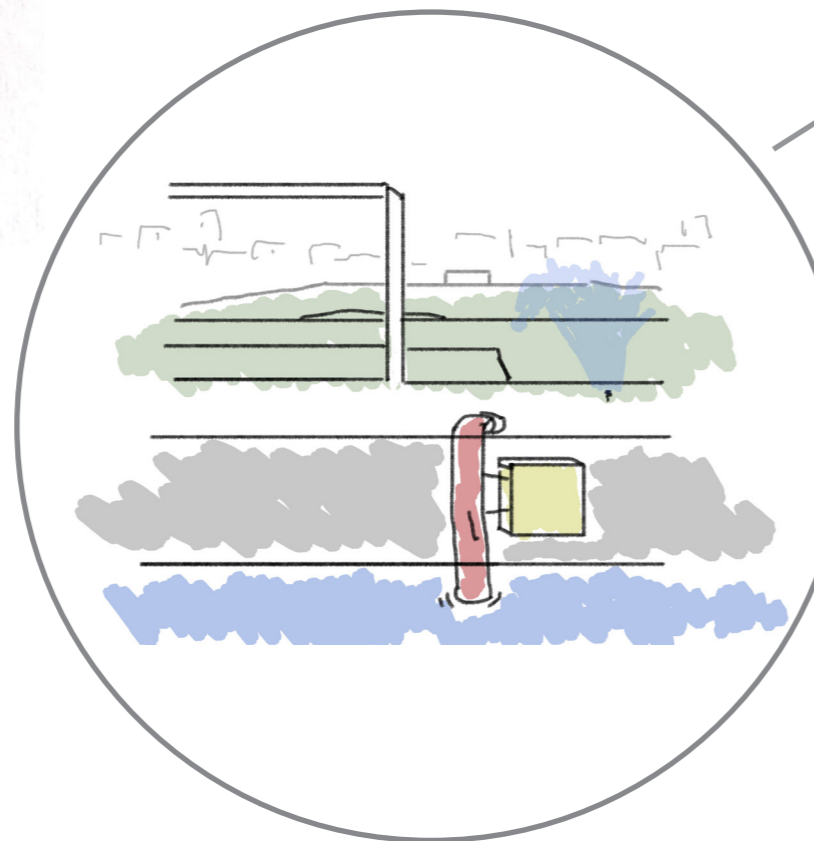
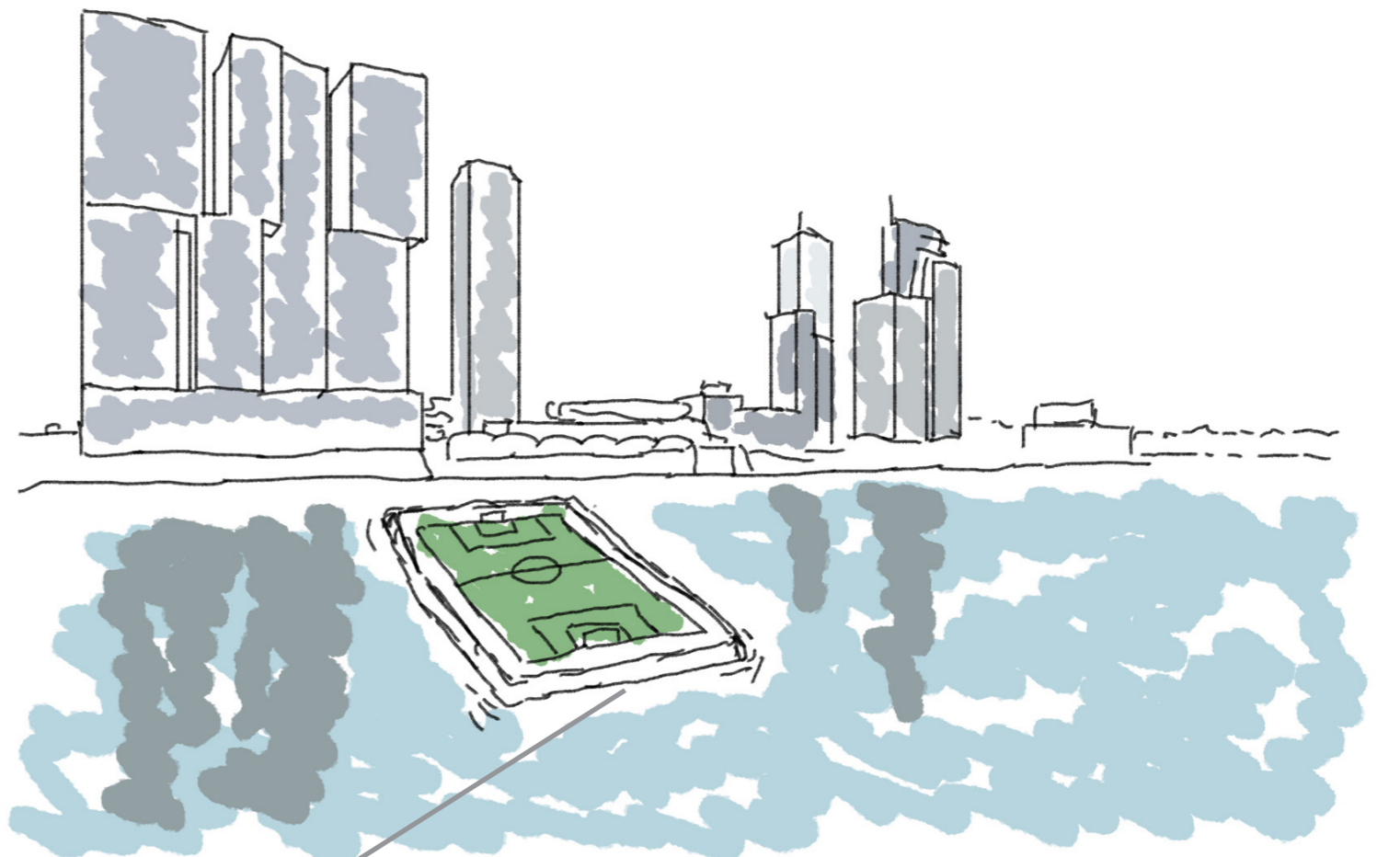

Michel Kessler

SeaSpace

Take a dip into our new workspace!

Located in the sea of Rotterdam, SeaSpace is the first and only coworking space in the region that focuses on a quiet and still comfy environment.

The idea of a floating workspace is brandnew and comes with many positive aspects. Because you have to get there by waterbikes (provided by Seaspace itself) there won't be that many tourists or people who just want to hang out (even though you can - we recommend our beautiful terrace where you can see the skyline of Rotterdam).

The perfect working environment!

There are two locations and they're both placed at quiet calm spots in the sea where most of the big ships won't pass.

There is no noise except the sound of the waves and the fresh air is ideal for a productive day when you have to work on your projects.

We're very proud of our innovative waterbikes. Dutch people are used to normal bikes and cycling so it's the perfect way to get to our locations and still do something for your body - plus it's a LOT of fun! You may ask yourself: Isn't this totally exhausting?!

It would be! But our waterbikes are fit up with mini turbines which help you to move very quick. You don't harm any other being or mother nature through pollution because the turbines work (just like a normal bike) with a dynamo.

Our workspace is a real eyecatcher, you get there by modern waterbikes AND (to be honest) it's a really trendy place. And what would be better than go for a quick swim after a hard day of work?

Join SeaSpace, register yourself on our website and get productive in a totally unique and new setting!

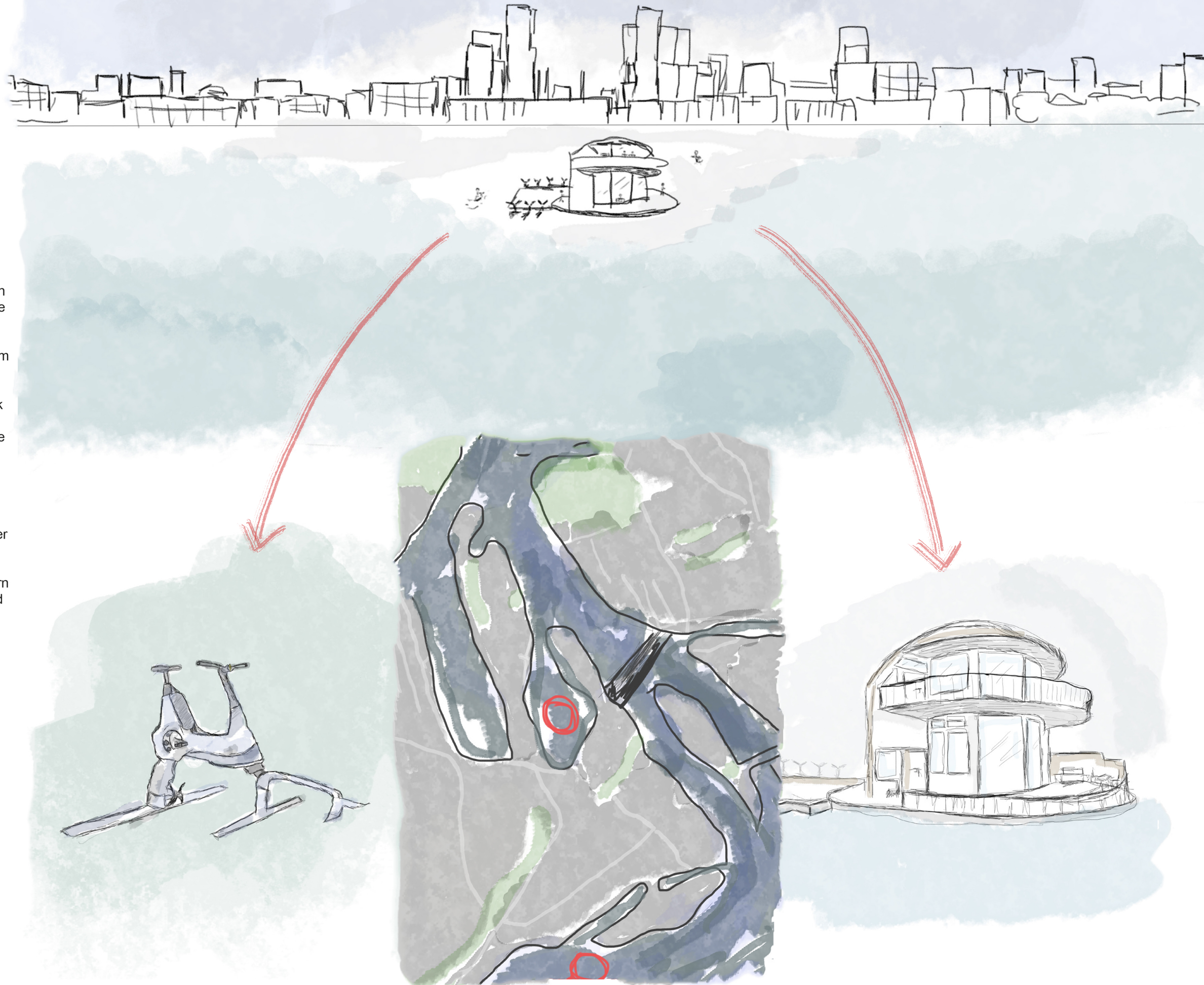

Buoyania

Floating Community Social & Sustainable

When it comes to locating, Buoyania could either be placed around the **harbour area** or - eventually in even bigger scales - directly on the **coast** outside the city.

The complete outer ring of the construction consists fully of **solar panels** supplying the mini city with sustainable electricity.

Sea level is rising and hundreds if not thousands of **houses** will have to be built in and around Rotterdam within the following few years. Buoyania is an attempt to face these challenges in the most efficient way possible.

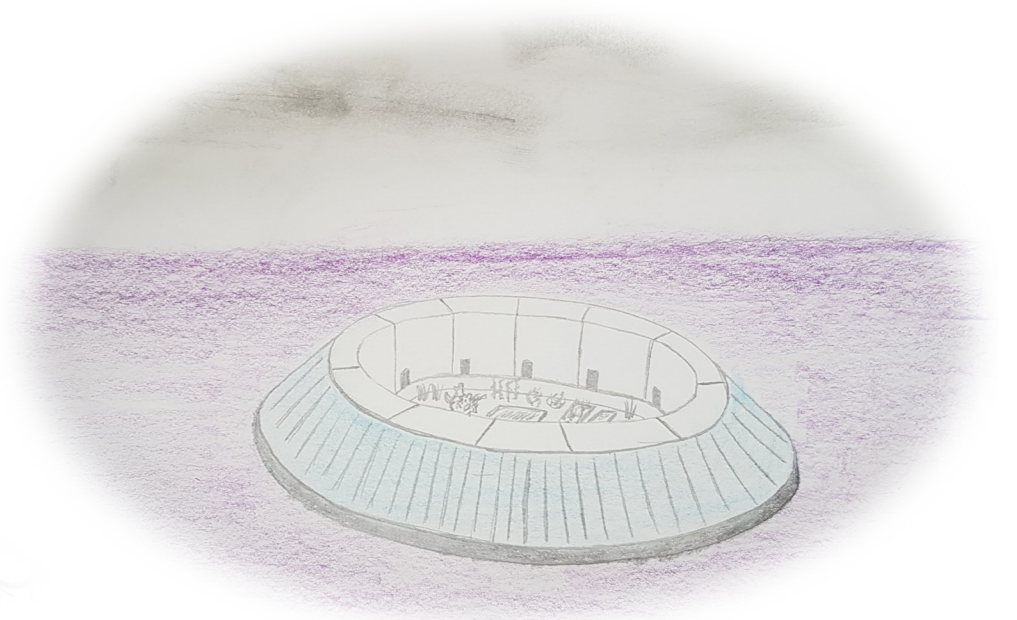

By its inclusive shape, Buoyania is supposed to bring its inhabitants **closer together** and encourage them to support each other in their daily life.



Inside the construction there's a large **gardening area** offering space for relaxing, family live and all sorts of social activities. Before all however, it is ment to allow the inhabitants to be as **self-sufficient** as possible.



Future Work

Lukas Kunz

Urbanization refers to the population shift from rural areas to urban areas, more often than not because of better job opportunities. This shift leads to a gradual increase of the proportion of people working and living in the cities and in the suburbs. Villages become towns and towns become cities and mega-cities. According to the United Nations 55% of today's world's population already lives in rural areas. It is predicted that by 2050 about 68% of the developing world will be urbanized.

The same phenomenon can be observed in the city of Rotterdam. With its gradual expansion rural areas are taken over by urban areas. Those who live in the city and those who commute from the outskirts or even nearby cities become victims of long and often uncomfortable daily duty stroke. Either you get stuck in traffic jams when moving from office to office or you don't find a suitable and comfortable working space when traveling with public or any other means of transportation. For many, time spent commuting from A to B is precious time wasted. This often leads to frustration, even more stressed out people and, at the end of the day, takes out the joy and drive of what is supposed to be a dream job.

This is why the idea of Future Work in the digital age is crucial. Future Work aims to generate purpose driven and resilient working concepts that harmonize the city of Rotterdam and the human beings that inhabit it with each other. Its goal is to contribute to a more sustainable work-life balance within the ever growing cities. This will then lead to a more grounded, less stressed out and more satisfied human being who will then perform better at his / her job. Maybe even finding THE solution to Rotterdams environmental challenges.

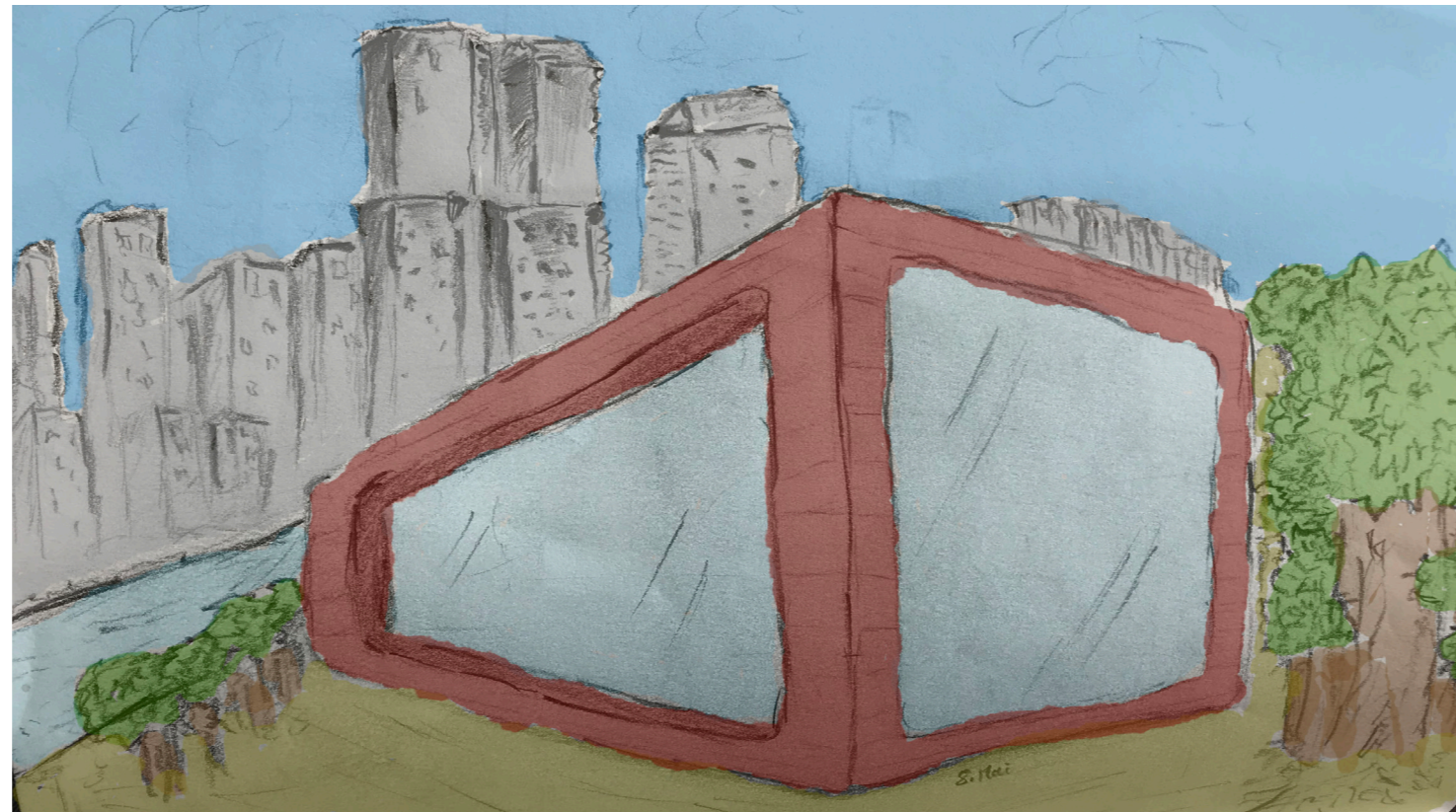

The concept called „Hub“ should bridge the gap between one's office from one's home and thus interlace nature with urban areas. Now this makes teleworking even more attractive. Because of the many parks that Rotterdam has to offer, these (mobile) working hubs could be placed anywhere and removed anytime if so necessary.

One of Rotterdam's iconic element is its enormous container yard at the harbour. The idea is to redesign them into comfortable and welcoming co-working spaces and conference areas. Not only are they representative for Rotterdam's culture but they also come in different colors, which can add to the greyish skyline and underline the multifacetedness of this city.

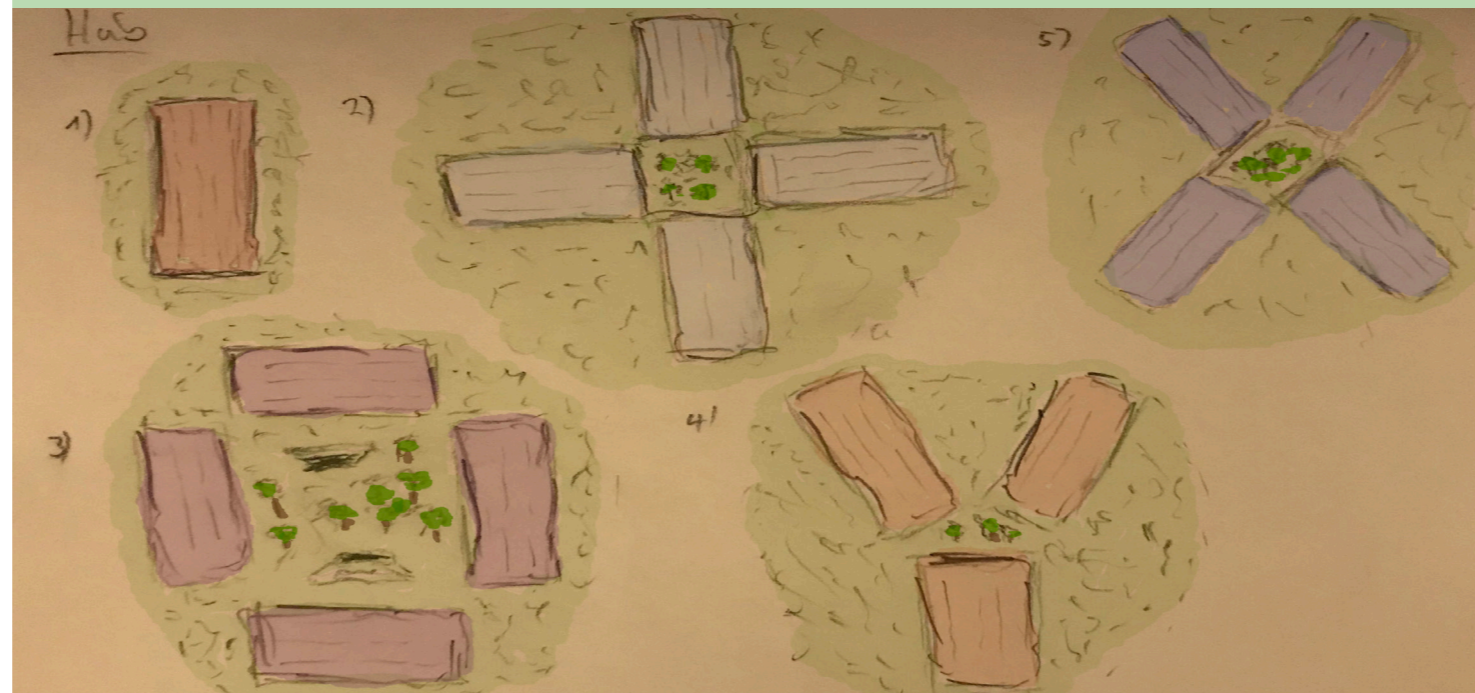

The picture depicts an overview of possible container formations that can be set up. These formations are specifically designed to bring a sense of community to the work space. This foundation of a community is interaction, which then effects in better integration of the different cultures inhabiting Rotterdam. Since the co-working spaces are on public spaces, they are accessible to everyone who wants to find a suitable place to work on their ideas, projects or even more serious stuff. Combining work with nature instead of rush hours has a positive impact not only in professional but also private environments.

The idea of the Hub is for it to gather people from all over city and offer them a nicely designed, partly self sustainable co-working space in urbanized nature with direct access to the park and picknick areas.



The inside of the Hub offers several individual and conference working spaces as well as free WIFI connection. Solar panels on the roof provide the electricity necessary for the space to work.

The side walls would have to be transformed into big glass windows in order to let sun light in. Both the natural light and the panoramic view of the park enriches the place positively as it gives the impression to be part of nature.

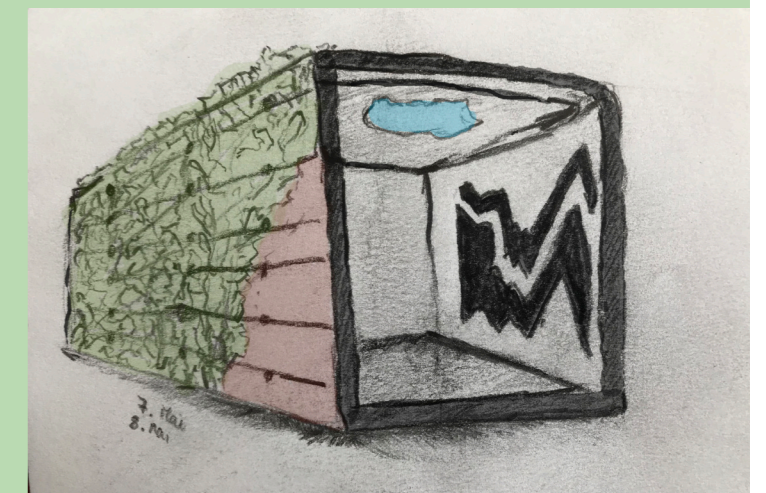

The inner and outer design of the containers don't have to be boring. The walls could be decorated with pieces of art, the ceiling could be made out of glass, the outer walls could be decorated with wall climbing plants. There are no limits to what the co-working Hubs could look like. Be creative...



Janine Herzig

Hoog Wiel

My Idea is to connect the hinterland of Rotterdam to the urban areas with a bicycle tunnel. I think most of the people that live in the hinterland like it there, so they don't necessarily want to move to the city. With my idea i want to make it easier to get to the city fast without using a car. Since so many people in Rotterdam move by bike, I thought it would be practical if people from the hinterland could come to the city by bike too.

Since it is hardly possible that people come such a long way only by bike, i thought of a conveyor belt, which is powered by energy generated from the movement of the bikes. The conveyor belt is inside a glass tunnel, so it is protected from rain but people can still see the landscape.



Anyone who wants to use the conveyor belt has to attach a dynamo to their bicycle and keep on pedaling while they're on it. The energy that is generated from the people pedaling is used to power the conveyor belt. Like this the bikes can move way faster, than they would with only physical strength. On days when many people are using the tunnel the energy that is generated will be saved up so the conveyor belt can still run, when less people are using it.

